

PRC 建设

Pacific Rim Construction

BUILT TO DELIVER A BETTER WORLD

AECOM: designing and delivering better cities

共同构筑更美好的世界

AECOM: 设计与交付并重, 实现城市优化和升级

Inside:

Landscape designers ALN share the story of their first ten years
URABANPROJECTS designed ultra-luxury hotel opens in Beijing
New Benoy-designed arts centre a bold leap forward for Jakarta
Elena Galli Giallini / Spawton Architecture thrive under Chengdu
Studio505 applies kaleidoscope of colour to drab primary school

Hong Kong / PRC \$50

ISSN 1684-1956



9 771684 95009 80

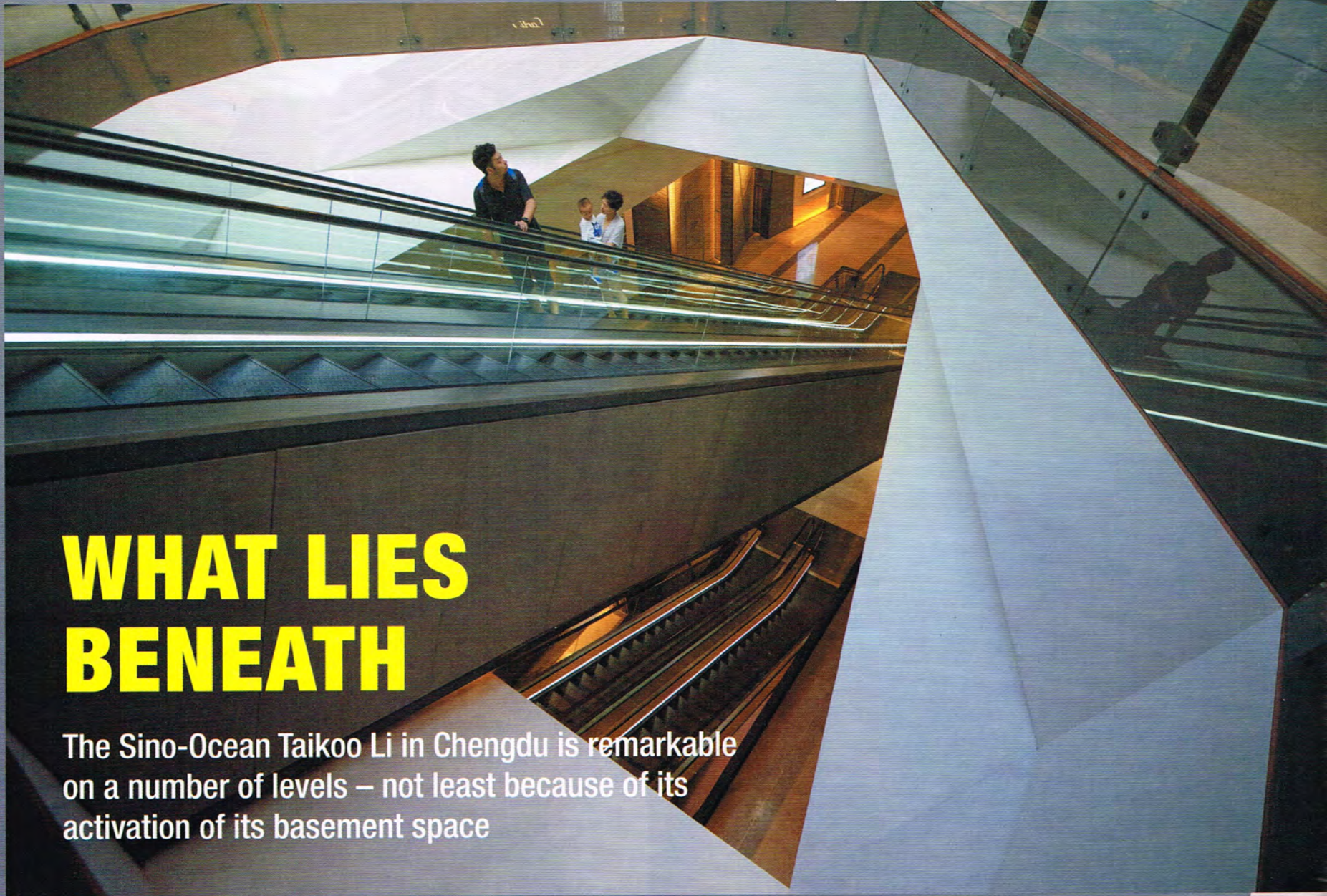

WHAT LIES BENEATH

The Sino-Ocean Taikoo Li in Chengdu is remarkable on a number of levels – not least because of its activation of its basement space

There is no question that Swire Properties' Sino-Ocean Taikoo Li retail project offers an international shopping experience that is unparalleled. The complex, in Sichuan's capital Chengdu, opened earlier this year, and combines a mixed-use complex with a retail centre, 100-room hotel, 42 serviced apartments and a 47-storey office tower over a 266,000 square metre site.

Sino-Ocean Taikoo Li Chengdu stands out for its striking design that interprets the traditional architectural style of the area. While there are new standards set above ground by a retail site that delivers a high-quality shopping experience set across three plazas connected by a series of lanes – one of which is built around the Daci Temple, built in 618 – the links to China's heritage and history also extend underground.

The basement mall and the related services is set over three levels and a gross floor area approaching about 18,000 square metres. The space incorporates access to the city's mass-transit railway, and contains a cinema, supermarket and bookshop.

These "essential" services aside, the subterranean retail space is an exemplar of the creative possibilities that are available to interior designers when it comes to activating basement space.

New and novel

Elena Galli Giallini Ltd and Spawton Architecture were offered a brief to define an interior for the lower ground arcade that would complement the remainder of the development and its distinctive site, while providing a strong interrelationship with the upper retail complex. The architects' project description calls for "juxtapositions of old and new, heritage and nature, place and history" as the essential themes.

The architects were conscious that modern shopping malls are hubs for urban populations and are spaces where people work, play, eat and shop. But they wanted their design to be novel and for the underground space to set the mall apart from conventional images and formulas.

"The site features heritage buildings throughout with the Buddhist Daci Temple as the composition focus," the architects told PRC Magazine. "These surroundings constituted challenges and constraints yet created opportunity to provide complexity within the scheme. A vibrant environment, attractive visual elements and multiple amenities are key to providing leisure and entertainment for compelling experiences for customers."

The team began by taking inspiration from the underground world of the Chinese landscape with the design relating to symbolic Chinese motifs and the natural environment to complement the heritage-led design of the complex above.



Information and Images: Elena Galli Giallini Ltd and Spawton Architecture

A centre for energy

They used rocks and stone symbolism and the imagery of caves and their complex system of “worlds within worlds”, along with underground streams, lakes and “skylights” as reference points for their design. In particular, caves are believed to have special purified qi, and they wanted to evoke that special energy.

“The design aimed to generate dynamism and distinction, while maintaining an atmosphere of coherency, serenity and refinement. The natural world is emphasised with the use of natural materials, stone, meshes and metals combinations with different colours, textures and finishes.”

The inspiration of the natural environment also influenced the arcade layout, with loops to evoke a sense of an underground stream, with a fluid, seamless design blending together the cluster of shops.

The architects further extended the imagery of the stonework and the sense of the cave by incorporating fissures and hollows in the ceiling that integrate lighting and signage.

Stone and natural light are also brought to bear in the Chunxi Road metro station entrance, which then leads to the core of the arcade loop, unfolding like a traditional folded scroll.

The cave metaphor is at play in the escalator lobbies which open up to the arcades with stone-clad walls using granite and lava-stone rods with a variety of surface finishes further perpetuate the cave motif. The stone palette relates to the local materials of the surrounding heritage buildings.



Details that raise spirits

The “rock” panels forming the bespoke interiors were fabricated off-site and installed on-site to achieve a precision fit and keep costs down. Sculptural frames in GRC, encased within illuminated backdrops of glass rods and copper showcase the advertisement panels as jewellery boxes.

Even the washrooms have been designed to complement the liveliness and sculptural qualities of the overall design. Vigorous shapes hewn in a white and dark grey solid surface material and unconventional lighting help set apart these spaces from a typical washroom. A collection of freestanding sinks are clustered beneath mirror units suspended from the ceiling, folded planes line up to form cubicles and urinals purposely disguise their function with angled, multifaceted partitions.

The smaller details are delicately defined. There are metalwork highlights including a mix of grey steel and naturally burnished copper. Elsewhere, split rectangles form the door handles, and inclined glass balustrades are held in place with brackets crafted from solid metal. In totality, the clear-cut detailing balances the boldness of the scheme, generating eye-catching points of interest.

The project is LEED NC gold certified and advanced techniques such as Computational Fluid Dynamics (CFD) analysis, help ensure a high level of comfort and quality under many aspects.

Elena Galli Giallini Ltd and Spawton Architecture set out to create a tranquil space beneath a bustling city. “The design created an environment which relates precisely to the place’s history and culture, its local spirit, avoiding the trap of making an indistinct shopping mall,” the architects say.

“Materials, colours and lights enhance quality through subtle elegance, defining the mall identity. Spatial layout and features emphasise naturalness with sophistication. It finds a language which defines its character amongst the repurposed, traditional architecture above.”

地下别有洞天

成都远洋太古里被公认为杰出项目，当中显著特色包括开辟之地下空间。

太古地产在其远洋太古里零售项目中，塑造了一个无可比拟的国际级零售体验，于今年早前开业的大型综合零售项目用地总面积达266,000平方米，当中包括了拥有100间客房及42间服务式公寓的酒店以及47层高的办公楼。

成都远洋太古里的设计瞩目，尤其在于如何诠释该区的传统建筑风格，整个零售地段的地面成为了优质购物体验之最新典范，由一系列的购物街贯通不同广场，其中一个广场更围绕著近一千四百年历史的大慈寺来兴建，这种跟中国悠久传承及历史紧扣的绵密联系，更延伸至地下。

地下购物中心及有关公共服务设于总面积广达接近18,000平方米的三个楼层，整个空间可直达市内的公共交通铁路，当中亦并设有电影院、超级市场及书店。

除了这些不可或缺的服务外，整个地下零售空间堪称是赋予室内设计师信任让其发挥无限创意，在拓展地下空间时所作出的最佳典范。



面目一新及标新立异

Elena Galli Giallini Ltd 及 Spawton Architect 收到的设计大纲，是要求室内设计及地面商场的低层能充分配合整个发展项目以及充满特色的地段，同时与商场高层作强烈的联系；建筑师在描述项目时便以「新旧并列、传承与自然并列、所在地与历史并列」为重要主题。

建筑师深明现代的购物商场是都市人群的枢纽，也是大家工作、娱乐、饮食及消费的空间，但他们希望设计能标新立异，藉著地下空间的非一般外观及设计，让整个购物商场感觉别树一帜。

建筑师告诉《PRC 建设》杂志：「整个地段有多个历史建筑，而大慈寺更成为这些建筑组合的焦点，这种环境既是挑战亦是契机，为方案带来复杂性；充满活力、视觉上具吸引力的元素及各式各样的服务设施，统统成为寻求空闲和娱乐的顾客能获得卓越体验的关键。」

团队开始从中国传统的地下景观中汲取灵感，设计也渗入象征中国的图案及大自然环境等元素，从而衬托项目地面及以上部分以历史传承作主导的设计。

能源力量的中心

他们以岩石及石头作象征性主题，又在设计中加入了洞穴的形象及其“别有洞天”的复杂结构，以致地下河流、湖泊及“天窗洞”皆成为他们设计的参考点；尤其是洞穴往往被视为具有特别净化的“气”，设计师也希望能够唤起这些特别的能量。

「设计务求能衍生活力及卓越，却同时保持一致性、宁谧及精致的氛围，藉著天然材料、石材、以不同颜色、纹理及饰面所制的网格及金属，强调及打造一个自然的世界。」

大自然环境作为灵感泉源，也影响了整个商场的布局，当中以环路带出地下流水的感觉，流动及无缝的设计与商店群融为一体。

建筑师在整合了照明及指示牌的天花中加入裂缝和凹坑，进一步加强石刻的形象及洞穴的感觉。春熙路地铁站入口也采用了石材及引入天然光，直达商场环路的中心，犹如张开一张传统的纸轴。

洞穴这概念也在自动扶梯大堂中出现，往商场的石墙以花岗石及熔岩石条作修饰，加上不同表面处理的石墙，进一步延续洞穴主题，石材的色调也跟周遭历史建筑的本土材料相应。



注入神韵的细节

内部装潢的特别订制“石材”面板先在场外预制，后于现场安装，让安装更为精准并减低成本；玻璃纤维增强混凝土制造的雕塑框架被玻璃条及铜造的照明背景所围绕，广告版于当中就好像一个个的珠宝盒。

就连洗手间的设计也跟整体设计中的朝气及雕塑风格作巧妙配搭。白色及暗灰色的坚实材料、线条苍劲的形状加上非传统的照明，让洗手间感觉与众不同；一系列的独立式洗手盆置于从天花吊下来的镜子下面，此外又有一堆作折迭的平面排列一起，成为外观出现不同尖角的多用途间隔，实则却是厕间及便器。

许多较小的细节皆是经过精心定义及安排。有些金属附件特别以灰钢及天然风磨铜作装饰，门把像是分拆掉的长方形，带斜度的玻璃栏杆由坚固的金属支架所支撑牢固。整体而言，线条分明的细节正好与具气魄的方案形成平衡，设计的点点滴滴皆出现不同趣味，叫人目不暇接。

整个项目获得领先能源与环境设计新建案(LEED)金级认证，同时利用先进技术如计算流体力学(Computational Fluid Dynamics, CFD)分析，以确保多方面的高度舒适和质素。

Elena Galli Giallini Ltd 及 Spawton Architecture 著手在这个繁华城市的地下营造一个宁静空间，而建筑师表示：「这设计让购物商场具独特风格，所营造出来的环境准确地与这地方的历史文化及当地特色接轨。」

「材料、颜色及照明造就出含蓄的优雅，提高质素并为商场的位格赋予定义，具空间感的布局及特别强调精致的自然感觉，考虑到在其上端作崭新用途的传统建筑时，这设计就好像一套充分表达其风格性质的语言。」

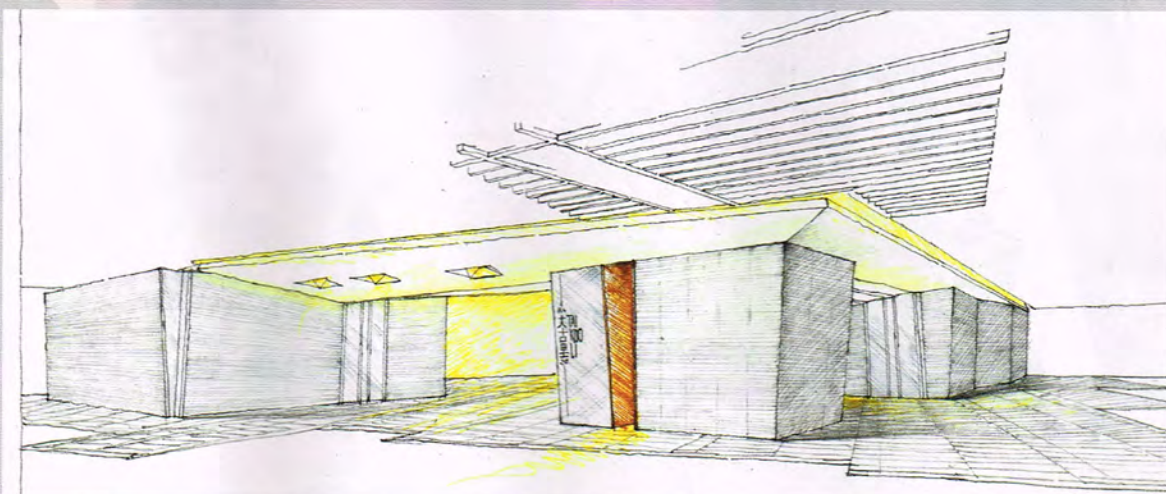

spawton
architecture
architecture | interiors | masterplanning